

ALLDATA[®]diy.com

Welcome ARMANDO RAMIREZ

Leading source of Online Diagnostic & Repair Information

AccountVehicleSearchContactExit

Your Vehicle: 2011 Suzuki Kizashi AWD L4-2.4L

Advertisement

Ask a Mechanic Online Now

32 Auto Mechanics are Online
Car Questions Answered Today: 380

Type your question here...

just answer[®]
POWERED BY

Get an Answer

[Vehicle](#) » [Brakes and Traction Control](#) » [Disc Brake System](#) » [Brake Pad](#) » [Service and Repair](#) » [Rear Brakes](#) » [Rear Brake Pad Removal and Installation](#)

Rear Brake Pad Removal and Installation

Rear Brake Pad Removal and Installation

Rear Brake Components

NOTE:

Failure to take proper precautions during brake pad removal may cause damage to the brake flexible hose and/or the brake piston.

- Be careful not to damage the brake flexible hose during brake pad removal.
- Avoid depressing the brake pedal during the brake pad removal procedure to prevent the brake piston from being forced out of the cylinder.

NOTE:

- Check for leakage of [brake fluid](#) when removing brake pads and repair [brake caliper](#) if leakage is found.
- Replace all the rear brake pads at the same time even if any rear brake pad needs to be replaced.

Removal

- 1) Remove console panel. [See: Body and Frame\Interior Moulding / Trim\Console\Service and Repair\Center Console Box Removal and Installation](#)
- 2) Release parking brake.
- 3) Loosen adjustment nut (1).

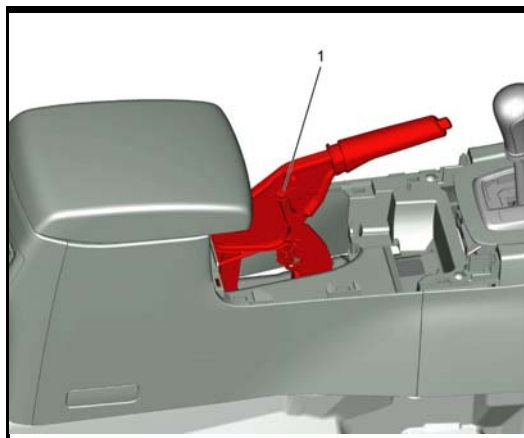

Zoom

Sized for Print

- 4) Hoist vehicle and remove rear wheel. [See: Maintenance\Wheels and Tires\Wheels\Service and Repair\Removal and Replacement](#)
- 5) Remove E-ring (1).

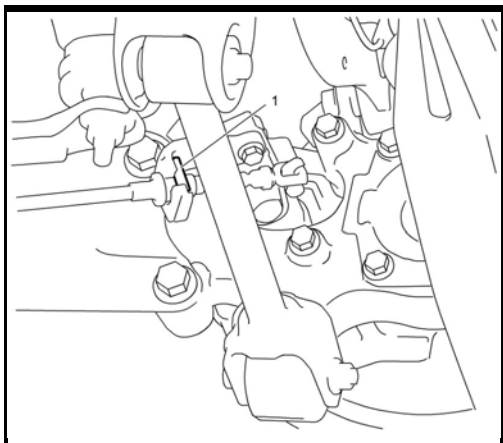
[Zoom](#)[Sized for Print](#)

- 6) Turn lever (1) in arrow direction and remove [parking brake cable](#) (2) from lever and bracket (3).

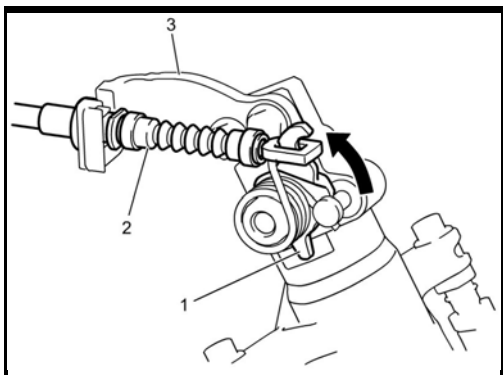
[Zoom](#)[Sized for Print](#)

- 7) Remove rear [brake caliper](#) pin bolts (1).

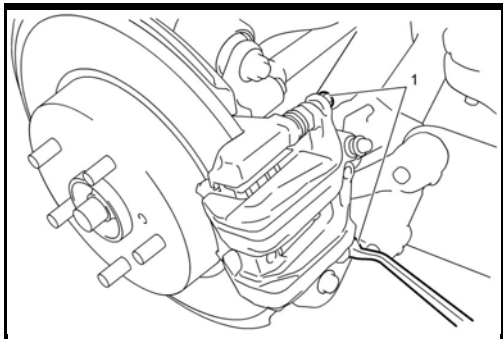
[Zoom](#)[Sized for Print](#)

- 8) Remove rear [brake caliper](#) (1) from rear brake caliper carrier (2).

NOTE:

If the removed [brake caliper](#) (1) is left hung by the brake hose, the brake hose may be damaged due to the tension caused by the caliper's weight.

Hang a removed [brake caliper](#) with a wire hook (4) or the like to relieve the brake hose of the tension.

- 9) Remove brake pads (3) and pad springs (5) from rear [brake caliper](#) carrier (2).

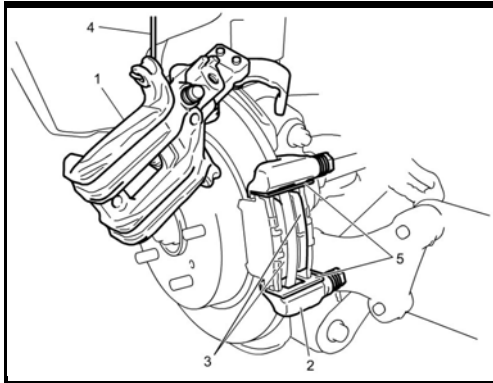
[Zoom](#)[Sized for Print](#)

Installation

Rear Brake Pad Inspection

Rear [Brake Caliper](#) Inspection

- 1) Apply brake grease in brake pad set to hatched area "A" between brake pad (2) and antinoise shim (1), and hatched face "B" between antinoise shim (1) and brake pad shim (3).

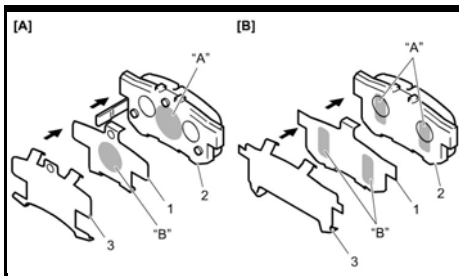
[Zoom](#)[Sized for Print](#)

[A]:	Inside	[B]:	Outside
------	--------	------	---------

[Zoom](#)[Sized for Print](#)

- 2) Install pad spring upper (1), pad spring lower (2), brake pad shims (3) and brake pads (4).

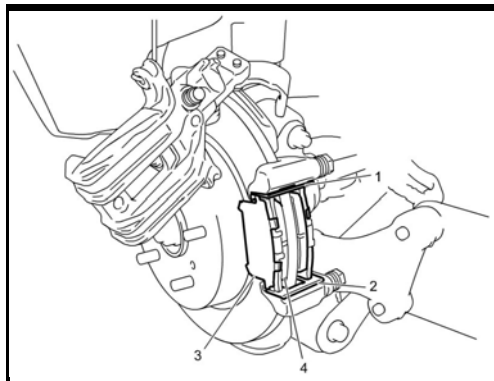
[Zoom](#)[Sized for Print](#)

- 3) Turn piston (1) in arrow direction by quarter to half turn using special tool to screw piston into caliper cylinder.

Special Tool

(A): 09945-16060

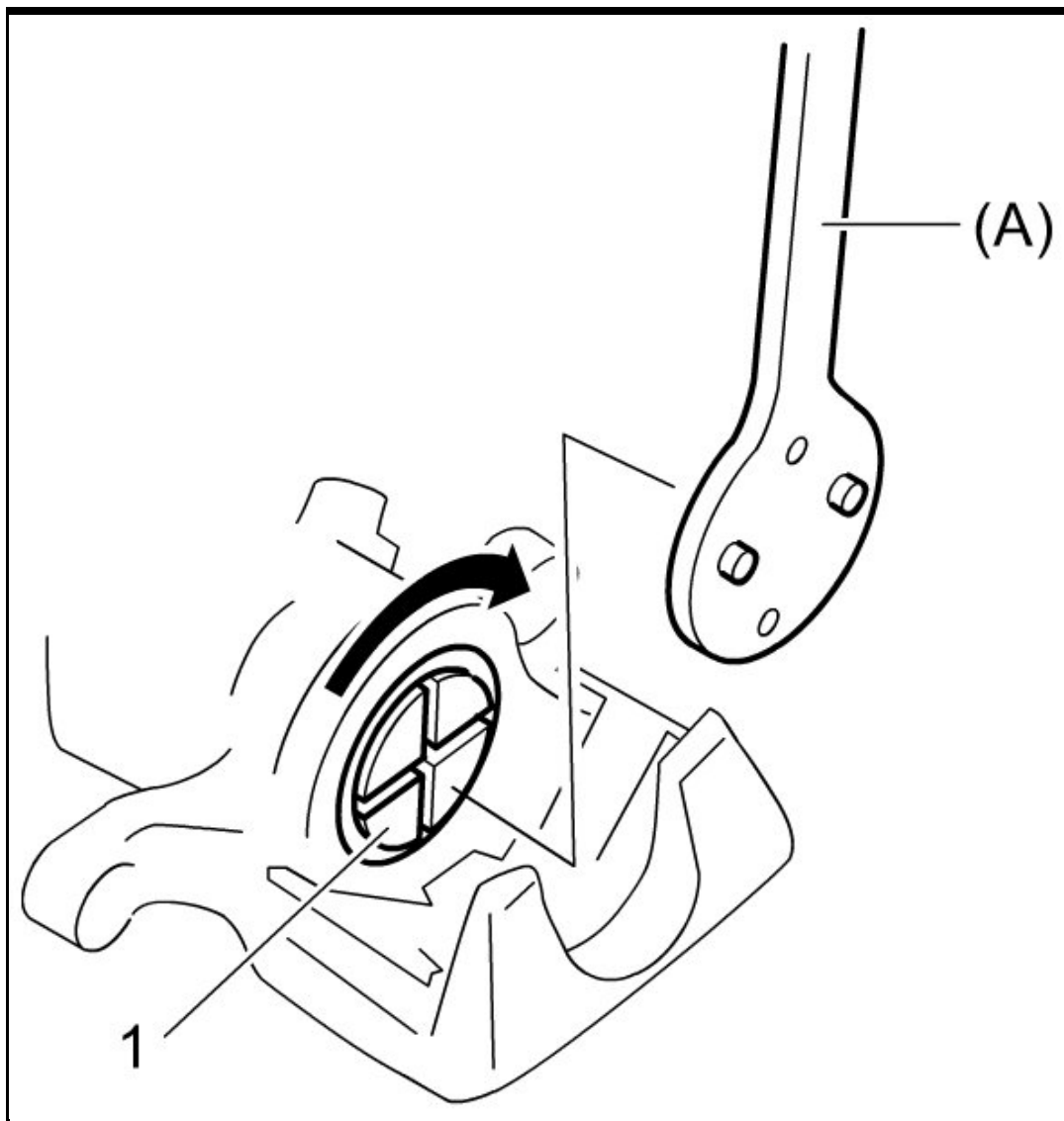

Zoom

Sized for Print

- 4) Install rear [brake caliper](#) cylinder while aligning slot of piston (2) with protrusion at back of brake pad (1).

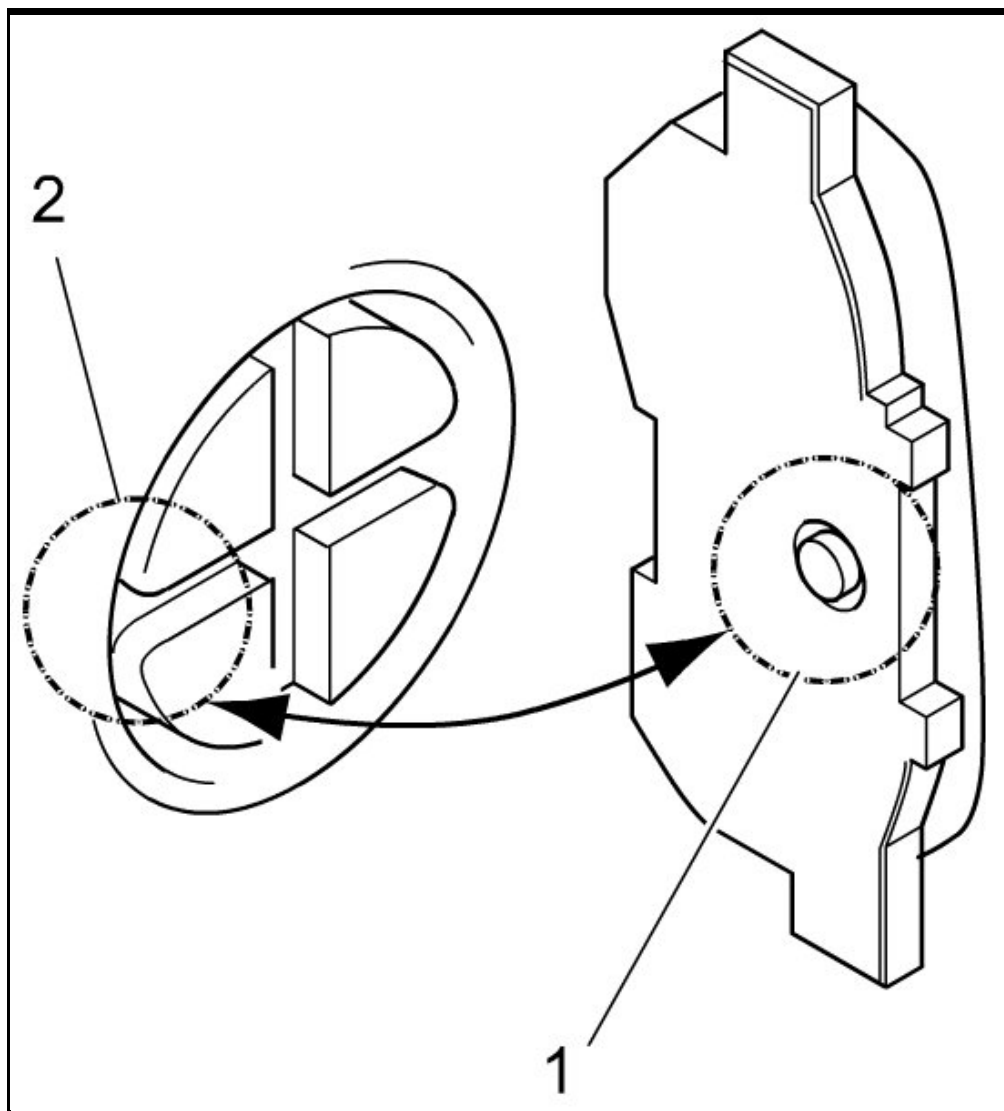

Zoom

Sized for Print

- 5) Install rear caliper (1) to rear [brake caliper](#) carrier and tighten rear brake caliper pin bolts to specified torque.

Tightening torque

Rear [brake caliper](#) pin bolt (a): 23 Nm (2.3 kgf-m, 17.0 lbf-ft)

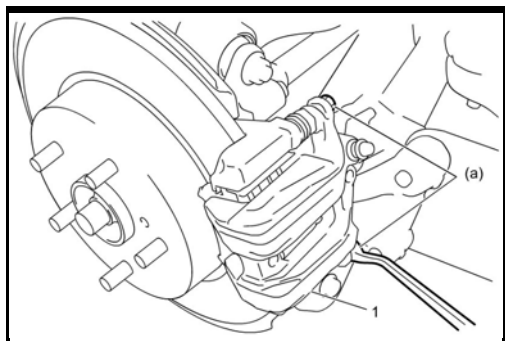
[Zoom](#)[Sized for Print](#)

6) Pass parking brake cable through bracket.

7) Align positions of parking brake cable (2) and bracket (3). Turn lever (1) in arrow direction and install cable (2) to lever (1).

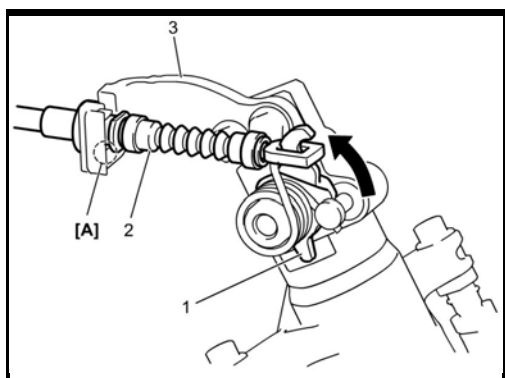
[Zoom](#)[Sized for Print](#)

[A]:	Positioning part
------	------------------

[Zoom](#)[Sized for Print](#)

8) Install E-ring (1) and fix parking brake cable (2).

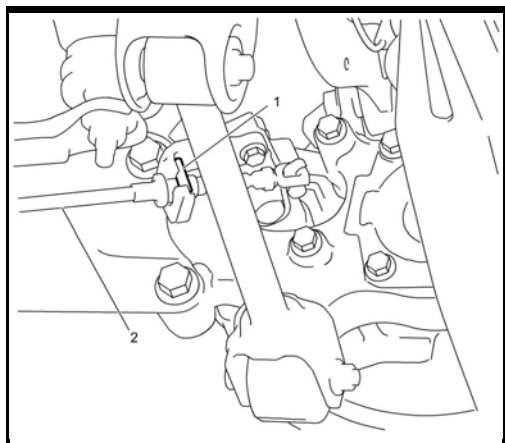

[Zoom](#)[Sized for Print](#)

- 9) Depress brake pedal three times or more with engine running to activate pad clearance adjustment mechanism so that clearance between rear brake disc and brake pad will be appropriate.
- 10) Check that brakes are not dragging and that appropriate stopping force can be obtained.
- 11) Install rear wheel and check if [parking brake lever](#) stroke is appropriate and if proper parking braking force can be obtained. [See: Parking Brake System\Adjustments](#)
- 12) Install console panel. [See: Body and Frame\Interior Moulding / Trim\Console\Service and Repair\Center Console Box Removal and Installation](#)

[Account](#) | [Vehicle](#) | [Contact](#) | [Exit](#)© 2013 ALLDATA, LLC. All Rights Reserved. [Trademarks](#) | [Privacy Policy](#) | [Terms and Conditions](#)