

2010 Suzuki Kizashi S

2010 ACCESSORIES AND BODY, CAB Seats - Kizashi

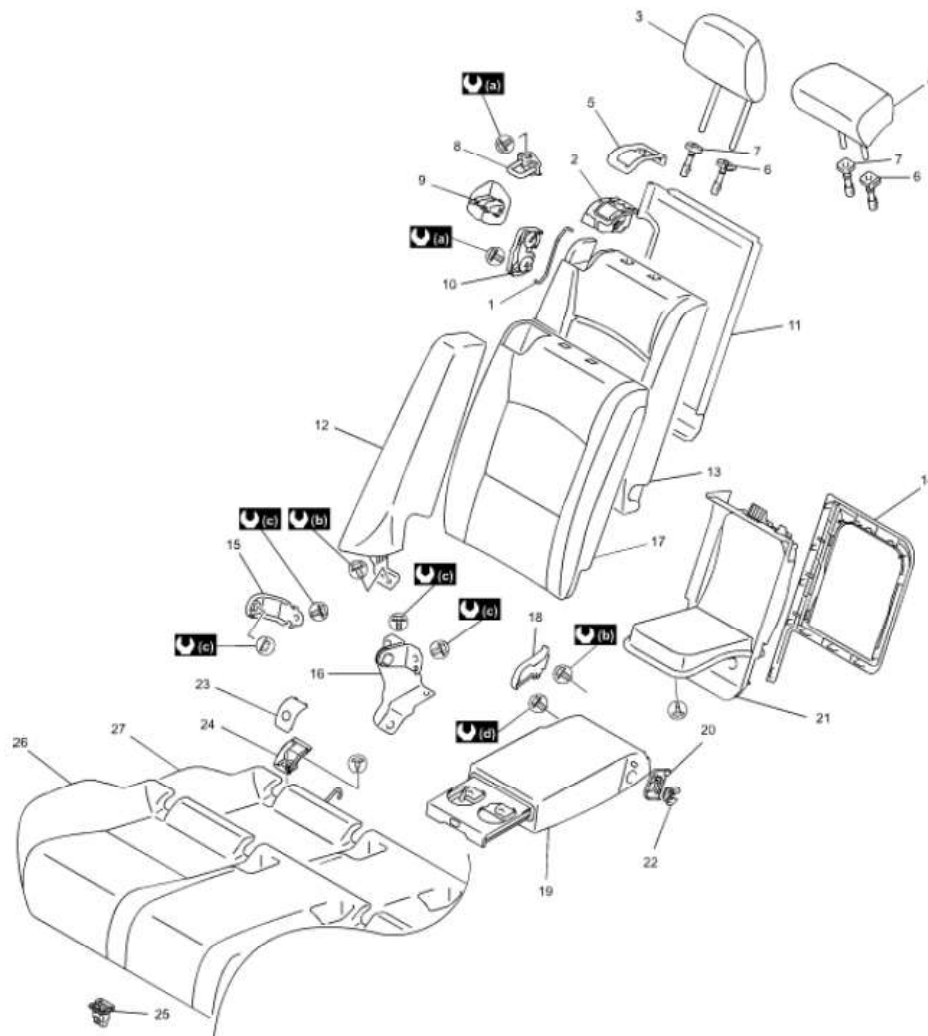

1. Seatback lock wire	12. Side back assembly	23. Lower anchor cover
2. Seatback lock knob assembly	13. Seatback assembly	24. Lower anchor guide
3. Headrest assembly	14. Armrest back board bezel	25. Seat cushion hook
4. Headrest (center)	15. Side hinge	26. Cushion trim
5. Seatback lock knob bezel	16. Seat center hinge	27. Cushion pad
6. Headrest guide (with lock)	17. Seatback trim	(a): 23 N·m (2.3 kgf-m, 17.0 lbf-ft)
7. Headrest guide (without lock)	18. Armrest hinge cover	(b): 5.5 N·m (0.55 kgf-m, 4.0 lbf-ft)
8. Striker	19. Armrest assembly	(c): 43 N·m (4.3 kgf-m, 31.5 lbf-ft)
9. Seatback lock hole cover	20. Armrest hinge spring	(d): 21 N·m (2.1 kgf m, 15.0 lbf ft)
10. Seatback lock assembly	21. Armrest back board assembly	
11. Seatback board	22. Armrest hinge bushing (L)	

Fig. 26: Identifying Rear Seat Components
Courtesy of SUZUKI OF AMERICA CORP.

REAR SEAT REMOVAL AND INSTALLATION