

9E

## Power Door Mirror Removal and Installation

### Removal

[Reference: Power Door Mirror On-Vehicle Inspection](#)

- 1) Remove front door trim. 
- 2) Disconnect power door mirror connector (1).
- 3) Remove door mirror nuts (2) and remove door mirror (3).

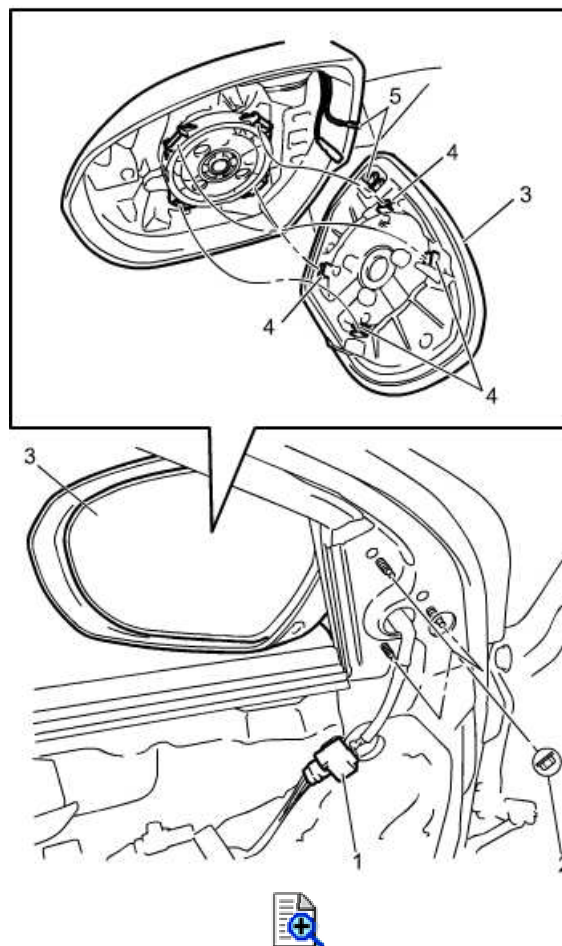

3. Door mirror	4. Claw	5. Heater wire (If equipped)
----------------	---------	------------------------------

### Installation

Reverse removal procedure noting the following points.

- Insert claws (2) securely when installing mirror (1).
- Check operation of door mirror after installation.
- Tighten door mirror nuts in order ("1" to "3") to specified torque.

#### Tightening torque

**Door mirror nut (a): 11 N·m (1.1 kg-m, 8.5 lbf-ft)**

