

9E

Front Door Glass Removal and Installation

Reference: Front Door Components

Removal

- 1) Lower front door glass to about 30 mm (1.18 in) from the lower edge of window.
- 2) Disconnect negative (-) cable at battery.
- 3) Remove inside handle cap (1) and trim cap (2).
- 4) Remove screws (3), clips, and remove door trim (4) by pulling it toward you.
- 5) Disconnect connectors of door harness.

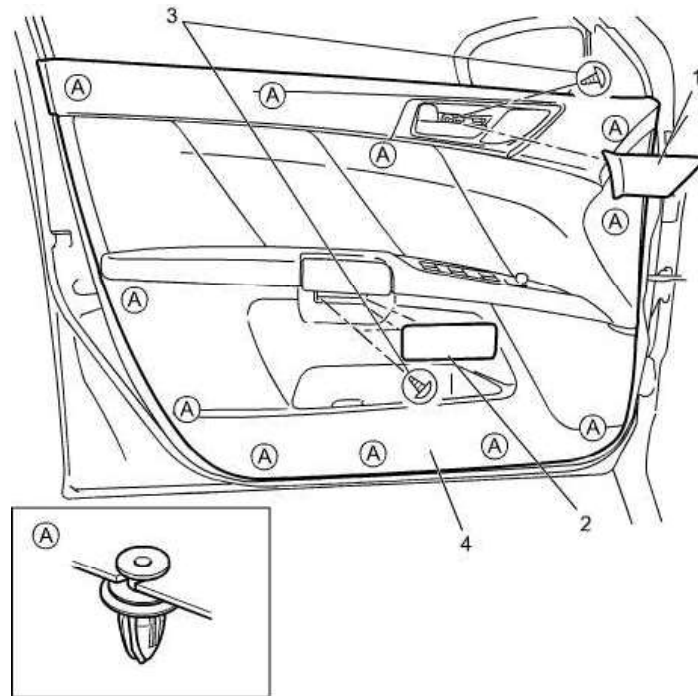

- 6) Remove front outer weather-strip (1) by moving it in arrow directions in order ("1" to "2") as shown in figure.